

# 2021



## ARCHITECTURE FOR HEALTH

SHOWCASE COMPENDIUM



Academy of  
Architecture for Health  
an AIA Knowledge Community

SHOWCASING TOP HEALTH CARE  
FACILITY DESIGNS

[archshowcase.org](https://archshowcase.org)

Inclusion of the projects and companies in the 2021 Architecture for Health Showcase Compendium does not indicate an endorsement of the project or company. To view more information and photos for the companies and projects included in the Compendium of Architecture for Health™, visit [archshowcase.org](http://archshowcase.org).

© 2021 American Society for Health Care Engineering (ASHE), a professional membership group of the American Hospital Association (AHA)

Printed in the U.S.A.

Cover image:

Vassar Brothers Medical Center Pavilion  
Poughkeepsie, NY

Designed by:

**CALLISON|RTKL™**

Photography by: Brad Feinknopf

The background of the page is a detailed architectural floor plan of a building, rendered in a light yellow color against a darker yellow background. The plan shows various rooms, corridors, and structural elements, with some areas highlighted in a slightly darker shade of yellow. The overall aesthetic is clean and professional, reflecting the architectural theme of the document.

# ARCHITECTURE FOR HEALTH

## SHOWCASE COMPENDIUM

The Architecture for Health Showcase provides several platforms for highlighting the latest health care facility design and construction projects. The Architecture for Health Showcase Gallery is exhibited at the International Summit & Exhibition on Health Facility Planning, Design & Construction (PDC Summit) and the Annual Conference & Technical Exhibition of the American Society for Health Care Engineering (ASHE). The Architecture for Health Showcase Compendium is the printed element of the program and is shared with attendees at the PDC Summit, ASHE Annual Conference and ACHA/AAH Summer Leadership Conference.

The showcase may be viewed online at [archshowcase.org](http://archshowcase.org). Visit this online gallery to learn more about the projects and firms featured in the compendium.

Questions about the Architecture for Health Showcase may be directed to Senior Publication Specialist and Editor Eliana Munro at [emunro@aha.org](mailto:emunro@aha.org) or 312-422-3817.

# TABLE OF CONTENTS

- |           |   |           |   |
|-----------|---|-----------|---|
| <b>3</b>  | <b>2021 Vista Award Winner</b><br>Parkland Hospital<br>Dallas, TX   | <b>11</b> | <b>Hasenstab Architects</b><br>Lake Health Beachwood<br>Medical Center<br>Beachwood, OH                                 |
| <b>4</b>  | <b>BSA LifeStructures</b><br>Children's Mercy Research Institute<br>Kansas City, MO                         | <b>12</b> | <b>HDR</b><br>Parkland Hospital<br>Dallas, TX   |
| <b>5</b>  | <b>c a ARCHITECTS</b><br>Cherese Mari Lauthere<br>Children's Village<br>Long Beach, CA                      | <b>13</b> | <b>NK Architects</b><br>SUN Behavioral Health<br>Erlanger, KY   |
| <b>6</b>  | <b>CallisonRTKL</b><br>Vassar Brothers Medical Center Pavilion<br>Poughkeepsie, NY                          | <b>14</b> | <b>Perkins&amp;Will</b><br>University of Virginia Health System<br>University Hospital Expansion<br>Charlottesville, VA |
| <b>7</b>  | <b>CRGA Design</b><br>Live-Work Wellness Development<br>Mexico City, Mexico                                 | <b>15</b> | <b>The S/L/A/M Collaborative</b><br>Doylestown Hospital Cardiovascular<br>& Critical Care Pavilion<br>Doylestown, PA    |
| <b>8</b>  | <b>ESa (Earl Swensson Associates)</b><br>Monument Health Rapid City Hospital<br>Rapid City, SD              | <b>16</b> | <b>Wold Architects and Engineers</b><br>Pipestone County Medical Center<br>& Family Clinic Avera<br>Pipestone, MN       |
| <b>9</b>  | <b>EwingCole</b><br>MSK Nassau<br>Uniondale, NY   | <b>19</b> | <b>Company Listings</b>   |
| <b>10</b> | <b>Flad Architects</b><br>Sarasota Memorial Health Care<br>System Radiation Oncology Center<br>Sarasota, FL |           |   |

# 2021 VISTA AWARD WINNER

Since 1993, the American Society for Health Care Engineering of the American Hospital Association has recognized design and construction initiatives across the United States through the Vista Awards program.

The Vista Awards recognize teams that work together to develop and maintain safe, quality health care environments; demonstrate effective and efficient communication; and rely on data-based decision-making processes.

The Vista Awards are granted based on team collaboration and focus on the project's key stakeholders — individuals who have been involved from inception to completion as well as during any post-occupancy evaluations.

For more information about the Vista Award program, visit [ashe.org/awards/vista](https://ashe.org/awards/vista).



## New Construction

Constructing a new facility, essentially from the ground up. The new facility may be connected to an existing facility, but the building must have its own identity and be a new space.

### Winner:

#### HDR + Corgan

Parkland Hospital  
Dallas, TX

Page 12





## BSA LifeStructures

# BSA

[bsalifestructures.com](http://bsalifestructures.com)

### Children's Mercy Research Institute | Kansas City, MO

Children's Mercy Research Institute is one of 31 exclusively pediatrics-focused research facilities in the U.S.

The nearly 400,000 SF, 9-story structure stands as a testament to the importance of translational medicine — research aimed at determining the relevance of pediatric diseases through novel discoveries.

The building's design communicates research that will take place within. The contemporary, all-glass facade highlights how science is integrated throughout: the design of the helix-inspired monumental stair, the DNA discoveries reflected in the curtain wall, and the artful balance between energy efficiencies and aesthetics. All these elements helped bring true collaboration to the forefront, allowing the true vision of the Institute to be realized.



**Square Footage: 400,000 |**

**Completion Date: September 2020**



c|a ARCHITECTS

# c|a ARCHITECTS

DESIGNING HEALTHCARE

c-aARCHITECTS.com

## Cherese Mari Lauhere Children's Village | Long Beach, CA

Light, color and energy come together to craft an active and engaging experience at The Children's Village at Miller Children's & Women's Hospital Long Beach. Filling a need in the community to create a place that supports a collaborative, efficient model of care, the new building brings a comprehensive array of children's outpatient services under one roof.

The Children's Village at Miller Children's & Women's Hospital Long Beach will serve the more than 84,000 children requiring ongoing, specialized follow-up care. The Village will bring all of Miller Children's & Women's pediatric specialties under one roof in a light, colorful and energetic setting, thus increasing patient satisfaction for those who have needed it most.

Light is cast through colored glazing, boldly illuminating interior lobbies, and color becomes a playful and intuitive organizational tool. The new Children's Village celebrates the energy of all children and encourages heroic families and caregivers through dynamic, bright, active spaces and playful, engaging architecture.



**Square Footage: 80,000 | Completion Date: February 2021**



CallisonRTKL

# CALLISONRTKL™

[callisonrtkl.com](http://callisonrtkl.com)

## Vassar Brothers Medical Center Pavilion | Poughkeepsie, NY

With a focus on creating a patient-centered, healing environment, CallisonRTKL's design of the new 8-level inpatient pavilion at Vassar Brothers Medical Center (VBMC) in Poughkeepsie, NY, is centered around bringing clarity, flexibility and longevity to the campus. The new pavilion will become a destination for world-class care, the flagship for Nuvance Health and a long-lasting landmark for the Hudson Valley community.

The addition boasts 290 private patient rooms and a new emergency department, loading dock, central plant expansion, interventional suite, conference center, cafe, helipad and lobby.

CallisonRTKL designed VBMC with a focus on sustainability and concentrated on aggressive energy- and water-efficiency prerequisites. VBMC demonstrates its goal of serving the community and offering world-class care for the long term by incorporating a 20% water use reduction target, solar shading on the west-facing facade, stormwater management, reduction in surface parking, vegetated roofs, accessible outdoor space and overall energy savings with a reduction in building usage.



**Square Footage: 752,000 | Completion Date: January 2021**





CRGA Design

# CRGA DESIGN

ARCHITECTURE  
INTERIOR DESIGN  
PLANNING

[crgadesign.com](http://crgadesign.com)

## Live-Work Wellness Development | Mexico City, Mexico

CRGA Design, as part of a large Mexico-based development team, was responsible for designing a large, multi-use development to function as a comprehensive live-work wellness neighborhood. The project, sited in central Mexico City, is a unique multi-use and culturally based health care campus. Included in the program for this project is 1.2 million square feet of space — including a 120-bed acute care hospital, a 130,000 SF medical office building, over 600 residential units of both condos and rentals, a 200-room hotel, and extensive retail and cultural space. With an in-depth understanding of the lifestyles and needs of the local population, our new Live-Work Wellness Center will contribute healing, living and cultural spaces that will have a positive impact on the residents of Mexico City and beyond.

**Square Footage: ±1.2 Million | Completion Date: 2022 (est.)**





## ESa (Earl Swensson Associates)



[esarch.com](http://esarch.com)

### Monument Health Rapid City Hospital | Rapid City, SD

Through master planning and design, the Monument Health Rapid City Hospital was transformed and rebranded for efficiencies and advanced delivery of care. The

expansion included the addition of patient beds for a transition to all private rooms, connected parking, improved wayfinding and the addition of integrated physician spaces. This is part of the largest construction project in the health care system's history.

A culture-based aesthetic is incorporated into the design to acknowledge the 30% of the patient population who are Native American. The area off the main lobby that would traditionally be deemed a chapel is a round spiritual room, reflecting sacred beliefs of the Lakota Nation and other local Native American cultures.

Flipping the main entrance from the north to the south, the campus is now reconfigured to better accommodate future growth. Providing registration and waiting areas at the main entrance, the atrium lobby offers improved wayfinding and connectivity to the new bed tower and the hospital office building.

**Square Footage: 260,000 (hospital); 80,000 (office building) |  
Completion Date: Summer 2020**

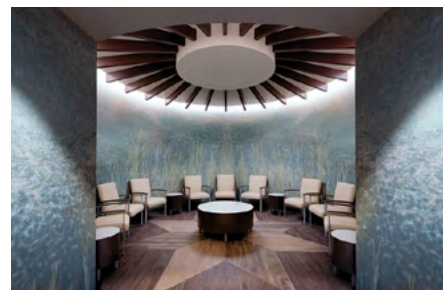



EwingCole

# EWING COLE

[ewingcole.com](http://ewingcole.com)

**MSK Nassau |  
Uniondale, NY**

This state-of-the-art cancer treatment center utilized both residential- and hospitality-based design concepts. Public spaces were rooted in smaller residential-scale “rooms,” bringing a more comforting personal scale to care being provided. Interactions between patients and staff were to be done side by side or knee to knee in intimate spaces throughout the facility, reinforcing the personal side of the patient’s path to health. Each space reflects qualities of rooms found in homes, whether it be the library, game room, attic, den or backyard. To facilitate purposeful waiting, multiple seating styles and options are provided while facility-wide Wi-Fi and easy access to power ensure patients and families can continue their typical work-life routines throughout their treatment.

The facility features comprehensive adult oncology services, including surgical, medical and radiation oncology consultations; chemotherapy and radiation therapy; diagnostic radiology; access to clinical trials; and other specialized services such as genetic counseling, pain management support, lymphedema therapy, survivorship services, social work and nutrition counseling.

**Square Footage: 114,000 | Cost: \$180 Million |  
Completion Date: 2019**





## Flad Architects



flad.com

### Sarasota Memorial Health Care System Radiation Oncology Center | Sarasota, FL

Sarasota Memorial Health Care System's new Radiation Oncology Center completes the first phase of the system's Cancer Institute. In support of the vision to provide devoted, comprehensive cancer care services, the center offers radiation treatment in a comfortable, spa-like environment.

The 18,000 SF facility is equipped with two linear accelerators that accurately pinpoint tumors, sparing healthy cells from radiation. This cutting-edge technology facilitates faster treatments, shorter recovery periods and improved outcomes. The center also includes a CT simulator, 6 exam rooms and physician offices.

Informed by feedback from hospital user groups, cancer patients and community members, the facility integrates advanced technology with holistic wellness elements such as a serenity garden and a supportive care suite. Filled with natural light, thoughtful artwork and soft colors, the center offers a respectful, calming experience — a welcome alternative to traditional radiation oncology centers.

**Square Footage: 18,000 | Completion Date: August 2020**

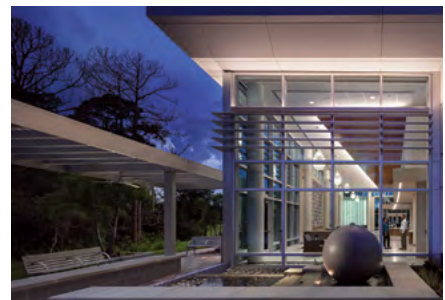



## Hasenstab Architects



hasenstabinc.com

### Lake Health Beachwood Medical Center | Beachwood, OH

The Lake Health Beachwood Medical Center was designed with the sophistication of a high-tech hospital within a smaller, tranquil health care setting. The 2-story acute care facility provides specialty services for orthopedics, urology, spine, general surgery and pain management.

The 1st floor contains a surgery department with 8 operating rooms, a central sterile supply, 24 pre-/post-op patient rooms, 2 small procedure rooms and associated support space. A small emergency department with a dedicated ambulance entrance is also included and consists of a reception/registration/triage area, 2 universal exam rooms, and radiology services with MRI, CT and X-ray capabilities.

The 2nd floor houses a patient care unit with 24 private patient rooms. Patient rooms are arranged around a central support core with 2 nurses stations and space for increased staff efficiency and visualization. Additional areas contain physicians' offices with 12 exam rooms and a dedicated X-ray, laboratory space, pharmacy, physical therapy area and staff lounge.

**Square Footage: 67,900 | Completion Date: February 2019**





HDR



[hdrinc.com](http://hdrinc.com)

## Parkland Hospital | Dallas, TX

HDR, in a joint effort with Corgan, designed the master plan of this new 64-acre health care campus, as well as the 862-bed, full-service, acute care replacement hospital. The Parkland campus is located within the Southwestern Medical District and serves as a teaching hospital for the University of Texas Southwestern School of Medicine.

From its inception, the design for the hospital was about its relevance in connecting to the city's urban fabric and importance as a civic anchor. Linear parks were used as major design elements for orientation and navigation.

The building massing, while iconic, is an honest expression of Parkland's health care program and operational requirements. The simple yet dynamic bars of the patient towers were designed around a universal private patient room. An onstage/offstage circulation approach introduced a more welcoming human scale to the large facility while protecting patient privacy and dignity.

Delivered within an IPD model, the project was delivered on time and on budget.

---

**Square Footage: 2.1 Million | Cost: \$1.27 Billion |  
Completion Date: November 2014**





## NK Architects



[nkarchitects.com](http://nkarchitects.com)

### **SUN Behavioral Health | Erlanger, KY**

NK Architects designed the SUN Behavioral Health and St. Elizabeth Healthcare behavioral health hospital to fill a critical need to help patients with mental illness and substance abuse disorders.

The 2-story facility includes 8 inpatient units and 197 beds for children, adolescents and adults. Each unit's inpatient rooms, day rooms, exam rooms, consult rooms, support spaces and secure courtyards are arranged in a V-shaped wing that permits direct views to patient rooms from the nurses station. The nurses stations are designed with wide counters instead of full partitions, providing safety with dignity.

The V shape also creates a variety of social spaces, from intimate two-person settings at the narrow end to open areas where people can gather. Daylight emanates from group rooms that anchor each wing and connect to the outdoors.

Outpatient, ED, physical therapy, gym, dining, activity, training and outreach spaces are located in the 1st floor central core.

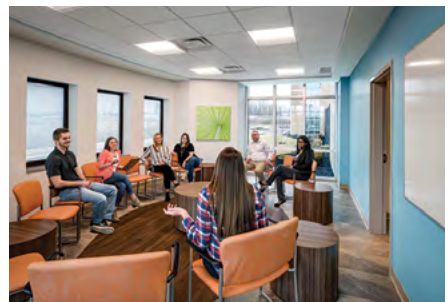

**Square Footage: 157,000 | Completion Date: 2018**



Perkins&Will

# Perkins&Will

[perkinswill.com](http://perkinswill.com)

## University of Virginia Health System University Hospital Expansion | Charlottesville, VA

This 168-bed expansion extends from the existing hospital with a fluid, curvilinear facade that creates a memorable entrance to the University Medical Center. A new lobby serves both the expanded emergency department and the remainder of the hospital. The new emergency department provides 82 treatment rooms organized into 7 modules of service, one of which is a pediatric unit with a dedicated waiting area and check-in. The expansion also includes an interventional platform containing 4 new operating rooms and 12 new interventional procedure rooms.

Levels 3 through 8 are designed to accommodate a 28-bed care unit, with universal rooms providing more appropriate hospital bedroom spaces for state-of-the-art care delivery. Relationships to the larger campus context are established through a welcoming entry sequence, a continuation of pedestrian-friendly landscaping, and the use of locally quarried sandstone common throughout the campus. Large expanses of glass provide sweeping views of the surrounding landscape, and lightweight shading devices manage heat gain and glare with minimum interference of patient views.

**Square Footage: 440,000 (new); 90,000 (renovation) |  
Completion Date: 2020**







## The S/L/A/M Collaborative



[slamcoll.com](http://slamcoll.com)

### Doylestown Hospital Cardiovascular & Critical Care Pavilion | Doylestown, PA

This new 3-story addition consolidates cardiac diagnostics and treatment space from multiple locations within the hospital to create a world-class heart institute. The project includes a 65,000 SF addition and phased renovations of 35,000 SF in the existing cardiac unit. One floor of diagnostic and testing areas with physician office space, a new 28-bed universal “one-stop” cardiovascular ICU, and shell space for 32 additional ICU beds on the 3rd floor are included. Renovations included the new endovascular hybrid OR, upgrades to the existing cath labs and a new PACU with a radial lounge to support new cardiac procedures. The cardiovascular ICU provides 28 private patient beds in universal rooms, allowing cardiac ICU and intermediate patient care to occur in the same room as the patient progresses in their recovery. Evidence-based design strategies were implemented throughout the unit, bringing best-in-class design and the latest research to develop an environment that promotes healing and addresses safety.

**Square Footage: 100,000 | Completion Date: 2020**





## Wold Architects and Engineers



woldae.com

### Pipestone County Medical Center & Family Clinic Avera | Pipestone, MN

As a result of the master planning process with Wold, Pipestone County Medical Center realized a need for an integrated clinic/hospital facility that included the replacement of an outdated wood frame clinic building.

The 3-story addition combines the current two entrances to the hospital into a single main entrance for the hospital and clinic, and includes a new single-story inpatient unit with a rooftop helipad.

Efficiency in operations was the primary strategic goal in the design. The existing hospital and clinic operated as two separate entities and were joined to improve user and provider efficiency. The final design created a new main lobby with local materials familiar to the region and a shared registration area for all patients. The result is a more efficient and inviting space with simplified wayfinding and organization.

In 2019, this small rural community came together to nominate the project for Soliant Healthcare's Most Beautiful Hospital award with over 2.3 million votes.

**Square Footage: 156,000 | Cost: \$24 Million |  
Completion Date: 2018**





The background of the page is a light yellow color with a faint, white architectural floor plan overlaid. The floor plan shows various rooms, corridors, and structural elements, including what appears to be a staircase and several doorways. The lines of the floor plan are thin and light, creating a subtle grid-like pattern across the page.

# COMPANY LISTINGS



## BSA LifeStructures

[bsalifestructures.com](http://bsalifestructures.com) | page 4

### ■ CONTACT

Melanie Harris  
Healing Practice Director  
[MHarris@bsalifestructures.com](mailto:MHarris@bsalifestructures.com)

### ■ LOCATION 1

6601 College Blvd., Suite 100  
Overland Park, KS 66211  
913-402-1100

### ■ LOCATION 2

9365 Counselors Row, Suite 300  
Indianapolis, IN 46240  
317-819-7878

### ■ LOCATION 3

107 N. 11th Street, Suite 702  
Tampa, FL 33602  
813-520-1551

Forty-six years ago, BSA was founded from the merger of an engineering and architectural firm, unusual and visionary for its time. Today, we exceed this vision as a national, integrated design firm that believes in the power of inspired solutions that improve lives.

BSA partners with our clients to enable growth beyond change and continue to transcend it. This propels our clients' visions forward and enhances the way our clients' customers feel through a seamless and curated patient experience.



## c|a ARCHITECTS, Inc.

[c-aARCHITECTS.com](http://c-aARCHITECTS.com) | page 5

### ■ CONTACT

Eileen Amano-Peterman  
President, Principal  
[ea-peterman@c-aarchitects.com](mailto:ea-peterman@c-aarchitects.com)

### ■ LOCATION

3633 Long Beach Blvd., Suite 200  
Long Beach, CA 90807  
562-595-5666

cla ARCHITECTS is built on over 40 years of architectural design solutions for California's health care leaders. Health care is in our DNA, and health care is all we do. Guided by collaborative expertise and innovative vision, resource stewardship and strong ethics, our purpose-driven designs consistently exceed our client and community's needs and expectations.

We are driven by a unified passion to create meaningful architecture to impact and inspire wellness.

# CALLISONRTKL™

## CallisonRTKL, Inc.

[callisonrtkl.com](http://callisonrtkl.com) | page 6

### ■ CONTACT

Jim Henry  
Senior Vice President  
[Jim.Henry@CRTKL.com](mailto:Jim.Henry@CRTKL.com)

### ■ LOCATION

200 S. Michigan Avenue, Suite 1800  
Chicago, IL 60604  
312-542-5900

CallisonRTKL (CRTKL) aspires to be a champion and catalyst for elevating the human condition by leveraging design and creative problem-solving to improve the places and experiences that shape our lives. By integrating our global expertise in health care, retail, workplace, hospitality and experience design, we deliver human-centric and community-focused solutions that embrace the changes going on in the world around us.

# CRGA DESIGN

ARCHITECTURE  
INTERIOR DESIGN  
PLANNING

## CRGA Design

[crgadesign.com](http://crgadesign.com) | page 7

### ■ CONTACT

Rolf Haarstad, AIA, LEED AP, ACHE  
Senior Vice President  
[rhaarstad@crgadesign.com](mailto:rhaarstad@crgadesign.com)

### ■ LOCATION

37 West Cross Street, Suite 300  
Baltimore, MD 21230  
410-841-2570

CRGA Design is a comprehensive architecture, interior design and planning firm dedicated to the practice of health care facility design. With 38 years of experience in the industry, CRGA partners with major health care systems in the mid-Atlantic region and maintains long-standing relationships with our clients built on demonstrated success. CRGA is comprised of over 30 driven, passionate professionals that work in a collaborative setting to design effective and environmentally friendly health care solutions.



## ESa (Earl Swensson Associates)

[esarch.com](http://esarch.com) | page 8

### ■ CONTACT

Sandy Dickerson  
Director of Communications/Marketing  
[sandyd@esarch.com](mailto:sandyd@esarch.com)

### ■ LOCATION

1033 Demonbreun Street, Suite 800  
Nashville, TN 37203  
615-329-9445

ESa (Earl Swensson Associates) provides global design services for acute care hospitals, outpatient facilities, specialty facilities, health and wellness centers, and medical office facilities. A charter member of the Planetree Visionary Design Network and an affiliate member of The Center for Health Design, ESa partners with for-profit and not-for-profit clients to create cost-effective, efficient environments that shape lives. For more information, visit [www.esarch.com](http://www.esarch.com).

# EWING COLE

## EwingCole

[ewingcole.com](http://ewingcole.com) | page 9

### ■ CONTACT

Andrew Jarvis  
Principal  
[ajarvis@ewingcole.com](mailto:ajarvis@ewingcole.com)

### ■ LOCATION 1

100 N. 6th Street  
Philadelphia, PA 19106  
215-923-2020

### ■ LOCATION 2

225 West 34th Street, 14th Floor  
New York, NY 10122  
212-897-4033

### ■ LOCATION 3

15231 Laguna Canyon Road, Suite 200  
Irvine, CA 92618  
949-417-7550

EwingCole is a nationally recognized architecture, engineering, interior design and planning firm of over 450 professionals. Health care design represents the core of our practice. For 60 years, we have formed collaborative relationships with our health care clients to create uplifting, efficient and encouraging experiences for patients, families and staff. EwingCole is located in Baltimore, Charlotte, Irvine, New York, Philadelphia, Pittsburgh, Raleigh and San Diego.



Flad

## Flad Architects

[flad.com](http://flad.com) | page 10

### ■ CONTACT

Jodi Mulcahy  
Principal, Director of Marketing and Strategy  
[jmulcahy@flad.com](mailto:jmulcahy@flad.com)

### ■ LOCATION 1

644 Science Drive  
Madison, WI 53711  
608-238-2661

### ■ LOCATION 2

2202 North Westshore Blvd., Suite 125  
Tampa, FL 33607  
813-830-6612

### ■ LOCATION 3

434 Fayetteville Street, Suite 1120  
Raleigh, NC 27601  
919-865-3523

Flad Architects is a national planning and design firm committed to creating environments that enhance human potential. Our primary body of work is focused on health care, medicine and the life sciences. These three areas converge in their primary mission of improving lives — delivering quality care, developing revolutionary new therapies for patients and providing world-class medical education.



## Hasenstab Architects, Inc.

[hasenstabinc.com](http://hasenstabinc.com) | page 11

### ■ CONTACT

Bob Medziuch, AIA, ACHA, NCARB, CSI, CCS  
Owner/Vice President  
[bmedziuch@hasenstabinc.com](mailto:bmedziuch@hasenstabinc.com)

### ■ LOCATION 1

190 N. Union Street, Suite 400  
Akron, OH 44304  
330-434-4464

### ■ LOCATION 2

700 W. St. Clair Avenue, Suite 300  
Cleveland, OH 44113  
216-298-4038

Hasenstab Architects provides planning, architectural design, interior design, structural engineering and civil engineering services. Since our inception in 1982, we have specialized in designing health care environments that promote healing, wellness and patient satisfaction. Our projects are frequently featured in local and national publications, and our team members have presented at national conferences throughout the United States.





## HDR

2021 Vista Award Winner – New Construction

[hdrinc.com](http://hdrinc.com) | page 12

### ■ CONTACT

Hank Adams  
Global Director, Health  
[hank.adams@hdrinc.com](mailto:hank.adams@hdrinc.com)

### ■ LOCATION

1917 S. 67th Street  
Omaha, NE 68106  
402-399-1000

At HDR, we believe that every health care environment should be as unique as its context. That's why we embrace a deep understanding of our clients' missions and then design with empathy for patient, family and staff experience. We're not a traditional health care architecture practice. Our DNA is diverse and collaborative. Our integrated staff advances care delivery that promotes health and well-being on a global scale and in local communities.



## NK Architects

[nkarchitects.com](http://nkarchitects.com) | page 13

### ■ CONTACT

Michael Gorman  
Chief Marketing Officer  
[gormanm@nkarchitects.com](mailto:gormanm@nkarchitects.com)

### ■ LOCATION 1

95 Washington Street  
Morristown, NJ 07960  
973-539-5353

### ■ LOCATION 2

233 Broadway, Suite 2150  
New York, NY 10007  
212-982-7900

### ■ LOCATION 3

100 S. Juniper Street, Third Floor  
Philadelphia, PA 19107  
215-515-4353

NK Architects is an integrated design firm with expertise in health care and education. Founded in 1972, we are a full-service architectural, interior design, planning and structural engineering firm committed to partnering with institutions that help shape the communities they serve.

# Perkins&Will

## Perkins&Will

[perkinswill.com](http://perkinswill.com) | page 14

### ■ CONTACT

Brian Sykes  
Associate Principal  
[Brian.Sykes@perkinswill.com](mailto:Brian.Sykes@perkinswill.com)

### ■ LOCATION 1

1250 24th Street NW, Suite 800  
Washington, DC 20037  
202-737-1020

### ■ LOCATION 2

410 N. Michigan Avenue, Suite 1600  
Chicago, IL 60611  
312-755-0770

### ■ LOCATION 3

1315 Peachtree Street NE  
Atlanta, GA 30309  
404-873-2300

We elevate the human experience and contribute to health. Perkins&Will is an interdisciplinary architecture and design firm founded on the belief that design has the power to transform lives and enhance communities. We collaborate with clients to create healthy places in which to live, learn, work, play and heal. We're passionate about human-centered design and committed to positively impacting people's lives through sustainability, resilience, well-being, diversity, inclusion and research.



## The S/L/A/M Collaborative

[slamcoll.com](http://slamcoll.com) | page 15

### ■ CONTACT

David D. Neal, AIA, ACHA  
National Healthcare Market Leader  
[DNeal@slamcoll.com](mailto:DNeal@slamcoll.com)

### ■ LOCATION 1

80 Glastonbury Boulevard  
Glastonbury, CT 06033  
860-657-8077

### ■ LOCATION 2

125 S. Dubuque Street, Suite 500  
Iowa City, IA 52240  
319-354-4700

### ■ LOCATION 3

8607 Venice Boulevard  
Los Angeles, CA 90034  
310-559-4717

SLAM is a 290-employee multidisciplinary architecture, engineering and construction firm located in nine offices across the country, including Atlanta; Boston; Denver; Glastonbury, CT; Iowa City; Los Angeles; New York City; Orlando; and Philadelphia. SLAM specializes in health care design, with a focus on person-centered design, Lean planning and design, and evidence-based design. SLAM designs healing environments that help our health care partners deliver the best care possible to the patients they serve.



# Wold Architects and Engineers

woldae.com | page 16

## ■ CONTACT

Josh Ripplinger, AIA, ASHE, EDAC, LEED AP  
Partner  
Jripplinger@woldae.com

## ■ LOCATION 1

332 Minnesota  
Street, Suite W2000  
St. Paul, MN 55101  
651-227-7773

## ■ LOCATION 4

220 N. Smith Street,  
Suite 310  
Palatine, IL 60067  
847-241-6100

## ■ LOCATION 2

214 Centerview  
Drive, Suite 300  
Brentwood, TN  
37027  
615-370-8500

## ■ LOCATION 5

1553 Platte Street,  
Suite 201  
Denver, CO 80202  
303-928-8800

## ■ LOCATION 3

113 North Liberty  
Street  
Jackson, TN 38301  
731-421-8000

Wold Architects and Engineers is a full-service planning, architecture and engineering firm with offices in Minnesota, Tennessee, Illinois and Colorado. A dynamic, growth-oriented company, Wold provides a wide range of services predominantly for health care and public-sector clients. The firm's expertise and experience include hospitals, clinics, critical access health centers, senior living environments, K-12 public schools, courthouses, fire and police stations, and city halls.





VIEW EXPANDED LISTINGS AT  
**[ARCHSHOWCASE.ORG](https://archshowcase.org)**